

The Pennsylvania / Delaware Chapter of the American Society of Landscape Architects invites you to participate in the

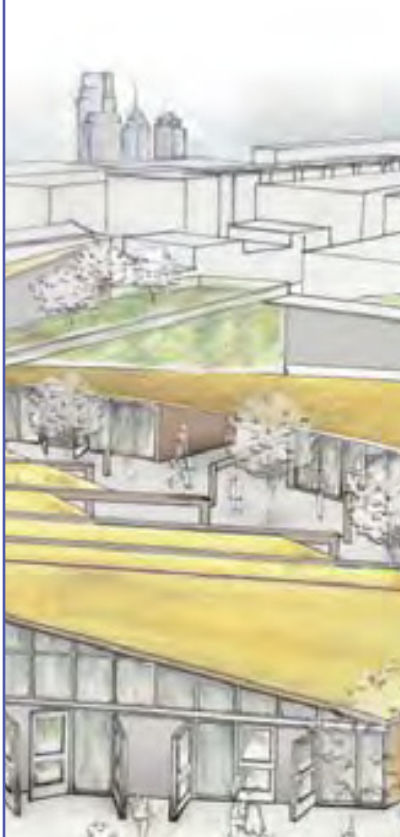

# STUDENT SCHOLARSHIP PROGRAM

## 2012



## Applications Due January 20, 2012

### Program

The PA-DE ASLA Chapter will award one (1) scholarship to at least one (1) student who is enrolled in the landscape architecture programs at universities within the Commonwealth of Pennsylvania or the State of Delaware. Scholarship recipients will receive **\$1,000** toward the registration, travel, and accommodation to attend a National ASLA Meeting and Expo.

### Eligibility

To be eligible for the scholarship, students must:

1. have successfully completed at least two (2) years in an undergraduate landscape architecture program or one (1) year in a graduate landscape architecture program;
2. be a Student Member of the ASLA; and
3. have maintained a cumulative grade point average of at least 3.0 on a GPA scale of 4.0.

PLEASE NOTE that you DO NOT have to be a graduate of a PA/DE high school as was the requirement in past criteria.

The university landscape architecture program can be either an undergraduate or graduate program and is not required to be an accredited program.

### Application Requirements

An applicant for a student scholarship shall submit the following information in electronic format to the Chapter Executive Director:

1. An essay, limited to a maximum of 500 words (no restriction on subject matter)
2. Graphic examples of work in Adobe PDF format.
3. A reference letter from a faculty member, including verification of cumulative grade point average.

### Submission

Applicants shall submit their application in electronic format to the Chapter Executive Director Office via e-mail: [bhendry@wannerassoc.com](mailto:bhendry@wannerassoc.com) by **5:00pm Friday, January 20, 2012**.

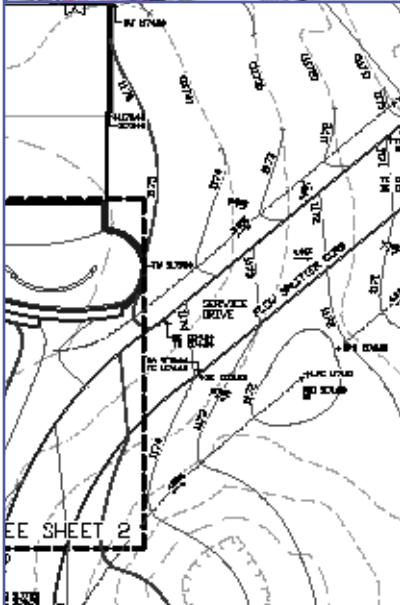

Please visit [www.padeasla.org](http://www.padeasla.org) for more information.