

BERGMAN.LOVALLO.TINSLEY
THE TIES THAT BIND

BREAKING NEW GROUND

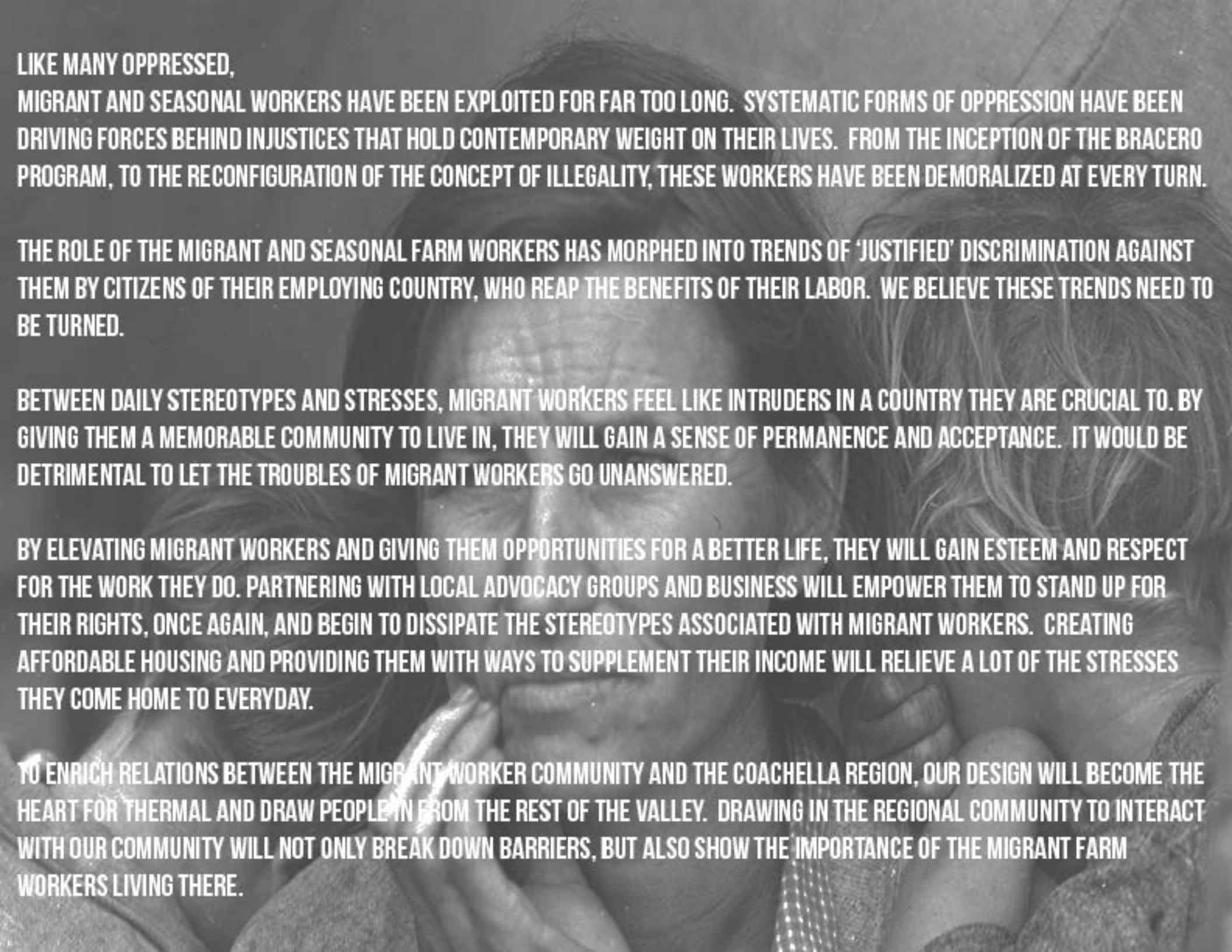

LIKE MANY OPPRESSED, MIGRANT AND SEASONAL WORKERS HAVE BEEN EXPLOITED FOR FAR TOO LONG. SYSTEMATIC FORMS OF OPPRESSION HAVE BEEN DRIVING FORCES BEHIND INJUSTICES THAT HOLD CONTEMPORARY WEIGHT ON THEIR LIVES. FROM THE INCEPTION OF THE BRACERO PROGRAM, TO THE RECONFIGURATION OF THE CONCEPT OF ILLEGALITY, THESE WORKERS HAVE BEEN DEMORALIZED AT EVERY TURN.

THE ROLE OF THE MIGRANT AND SEASONAL FARM WORKERS HAS MORPHED INTO TRENDS OF 'JUSTIFIED' DISCRIMINATION AGAINST THEM BY CITIZENS OF THEIR EMPLOYING COUNTRY, WHO REAP THE BENEFITS OF THEIR LABOR. WE BELIEVE THESE TRENDS NEED TO BE TURNED.

BETWEEN DAILY STEREOTYPES AND STRESSES, MIGRANT WORKERS FEEL LIKE INTRUDERS IN A COUNTRY THEY ARE CRUCIAL TO. BY GIVING THEM A MEMORABLE COMMUNITY TO LIVE IN, THEY WILL GAIN A SENSE OF PERMANENCE AND ACCEPTANCE. IT WOULD BE DETRIMENTAL TO LET THE TROUBLES OF MIGRANT WORKERS GO UNANSWERED.

BY ELEVATING MIGRANT WORKERS AND GIVING THEM OPPORTUNITIES FOR A BETTER LIFE, THEY WILL GAIN ESTEEM AND RESPECT FOR THE WORK THEY DO. PARTNERING WITH LOCAL ADVOCACY GROUPS AND BUSINESS WILL EMPOWER THEM TO STAND UP FOR THEIR RIGHTS, ONCE AGAIN, AND BEGIN TO DISSIPATE THE STEREOTYPES ASSOCIATED WITH MIGRANT WORKERS. CREATING AFFORDABLE HOUSING AND PROVIDING THEM WITH WAYS TO SUPPLEMENT THEIR INCOME WILL RELIEVE A LOT OF THE STRESSES THEY COME HOME TO EVERYDAY.

TO ENRICH RELATIONS BETWEEN THE MIGRANT WORKER COMMUNITY AND THE COACHELLA REGION, OUR DESIGN WILL BECOME THE HEART FOR THERMAL AND DRAW PEOPLE IN FROM THE REST OF THE VALLEY. DRAWING IN THE REGIONAL COMMUNITY TO INTERACT WITH OUR COMMUNITY WILL NOT ONLY BREAK DOWN BARRIERS, BUT ALSO SHOW THE IMPORTANCE OF THE MIGRANT FARM WORKERS LIVING THERE.

SITE INVENTORY

- RESTAURANTS (20)
- GROCERY MARKETS (25)
- SHOPPING MALLS (1)
- PHARMACIES/HOSPITALS (5)
- EDUCATIONAL FACILITIES (6)
- LIBRARY (1)
- CHURCHES (8)
- BANKS (4)
- GAS STATIONS (9)

- 75% FOREIGN BORN
- 25% U.S. CITIZENS
- 54% UNDOCUMENTED
- 30% HAVE WAGES BELOW THE POVERTY LINE
- 20% WOMEN
- 88% BORN IN MEXICO
- 65% HAVE ONLY WORKED ON A FARM
- 95% SPEAK SPANISH
- 71% CANT COMMUNICATE IN ENGLISH
- 97% SPEAK SPANISH AT WORK
- 58% DONT HAVE ACCESS TO FRESH WATER OR PRODUCE
- 42% MISS WORK DUE TO LACK OF TRANSPORTATION
- 87% DONT HAVE PRIVATE HEALTH INSURANCE
- 82% DONT HAVE A HIGH SCHOOL EDUCATION
- 54% HAVE CHILDREN UNDER 18

SITE LOCATION



THE URBAN COMMUNITY FORMS A PATTERNS OF RELATIONSHIP, FOLLOWED BY THE REGIONAL INFRASTRUCTURAL ARRANGING OF THE OROCHILLA VALLEY, THE INTENT IS TO STRENGTHEN POSITIVE SOCIAL TIES BETWEEN THE IMMEDIATE AND REGIONAL COMMUNITIES.



DESIGNED TO PROVIDE ACCESS TO PUBLIC SPACES OF URBAN BANDS THROUGH THE USE OF SAFE AND PUNCTUATED USE.



PATHWAYS ARE DESIGNED TO PROVIDE FLUID MOTION THROUGH THE SITE, FROM IDENTIFICATION WITH ALLEYS FOR OPTIMAL PLANNING CLIMATE CONTROL, PLAZA CENTRALIZED THROUGHOUT TO GET PROGRAMMATIC ELEMENTS AND PART IN SCALE TO COMPLEMENT THEIR ADJACENCY.



PLAN ITERATION 1
ATTEMPT AT PROGRAMMATIC ELEMENTS, CROOKING EVERY PARTNERSHIP TRENDS.



PLAN ITERATION 2
RECONFIGURATED PROGRAM ELEMENTS ALLOWING FOR PUBLIC AMENITIES IN ADDITION TO PARTNERSHIPS

PEOPLE

- BRING IN COMMUNITY FROM THE ADJACENT SOUTHERN STREET
- PULL IN PARTNERSHIPS REGIONALLY



PROFIT

- BRING IN LOCAL BUSINESSES
- CREATE ON SITE ENERGY THROUGH SOLAR PANELS



PLACE

- WAY FINDING SHELTERS ON SITE
- INCREASE WALKABILITY & PEDESTRIAN EXPERIENCE
- FRAME EXISTING VIEWS OF THE MOUNTAIN RANGE
- REDUCE WIDTH OF NORTHERN STREET ON SITE

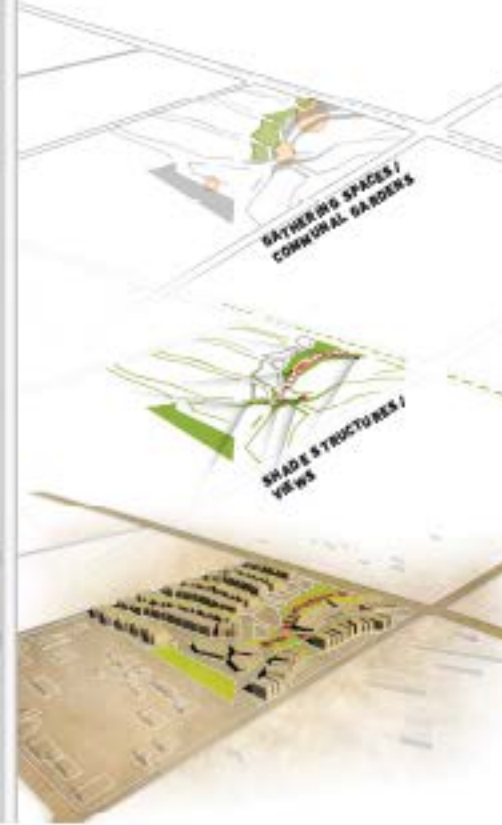

PLANET

- BRING IN COMMUNITY FROM THE ADJACENT SOUTHERN STREET
- PULL IN PARTNERSHIPS REGIONALLY

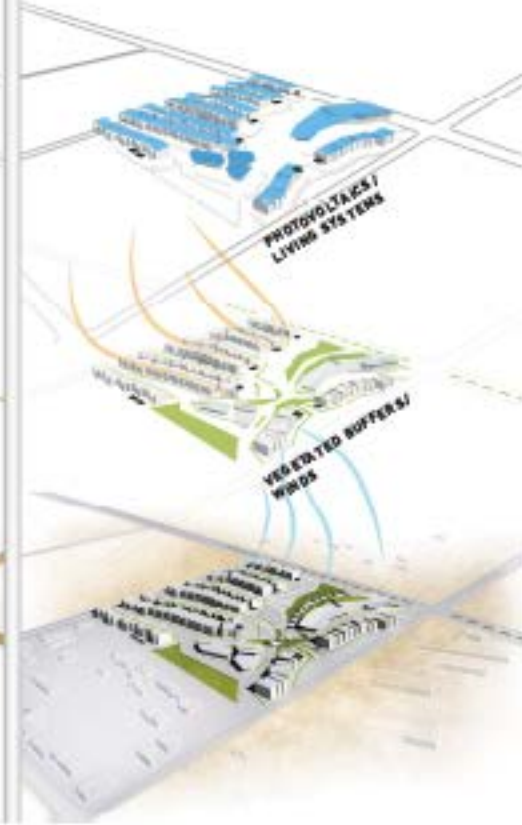

COMMUNAL GATHERING SPACES



SALSA & PRODUCE STANDS



COMMUNAL STAGE AREA



COMMUNITY GARDEN BEDS

LANDSCAPE RESPONDING TO ARCHITECTURE



LANDSCAPE CREATING NODES CREATING SPACE



LANDSCAPE RESPONDING TO SITE CLIMATE

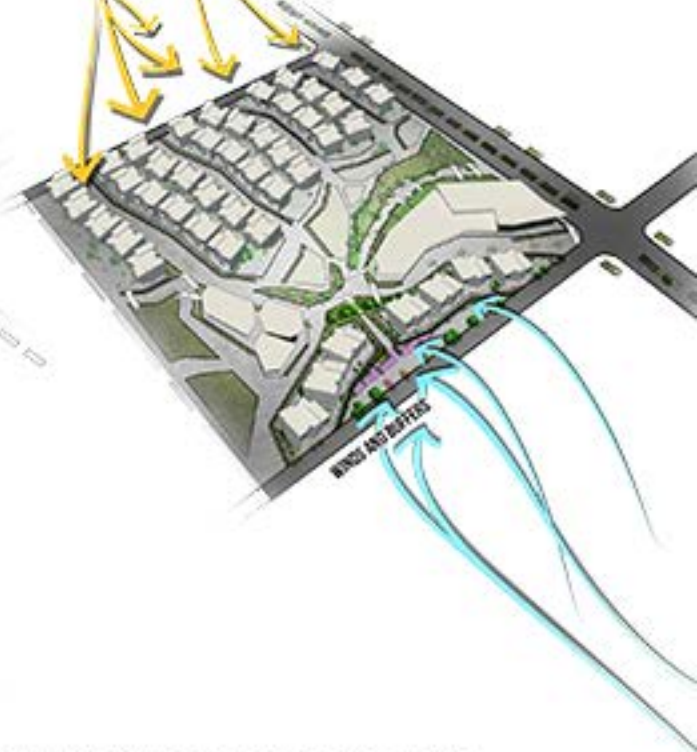

SHADE PROVIDING CANOPY TREE: CALIFORNIA FAN PALM

DROUGHT TOLERANT NITROGEN FIXER: MESQUITE SP.

LOWER CANOPY SHADE PROVIDING TREE: BLUE PALO VERDE

MEDIUM BLOOMING SHRUB: DESERT FIR

GROUND COVER & CACTI SP.

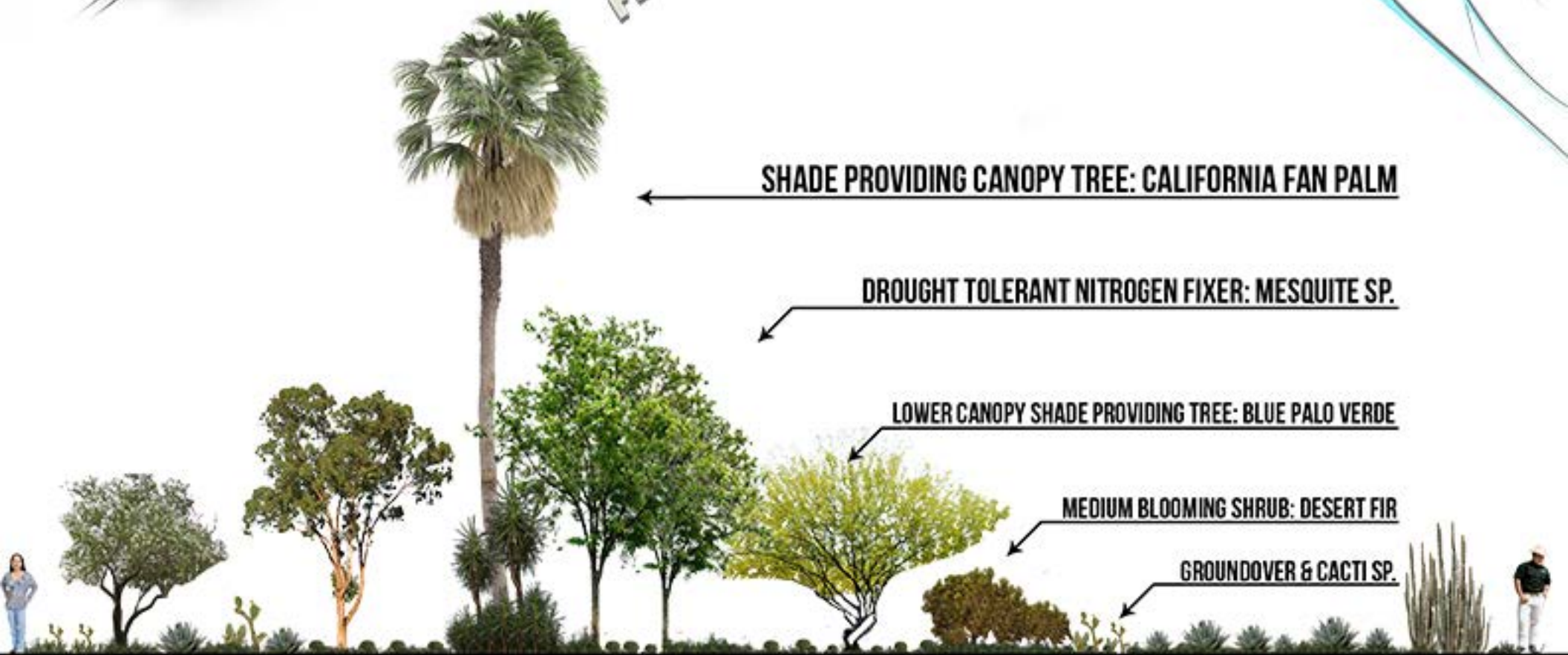

CULTURAL TIES THROUGH ARCHITECTURE

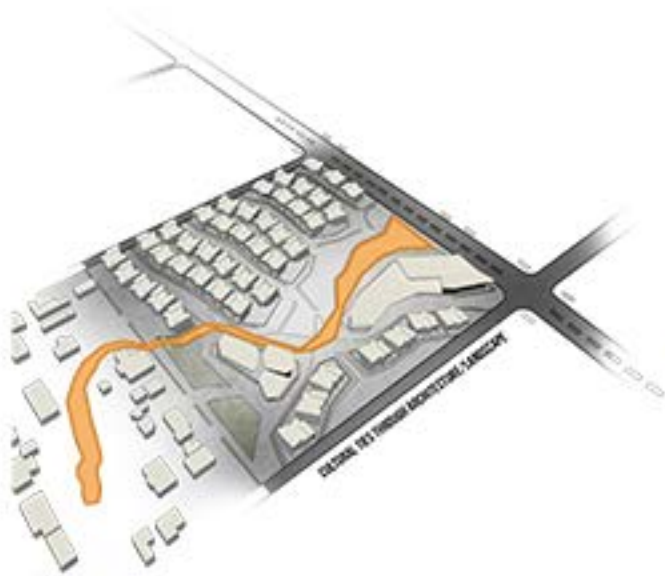

PUBLIC VS. PRIVATE SPACE ON-SITE



SOLAR PANELS FOR ALTERNATIVE ENERGY

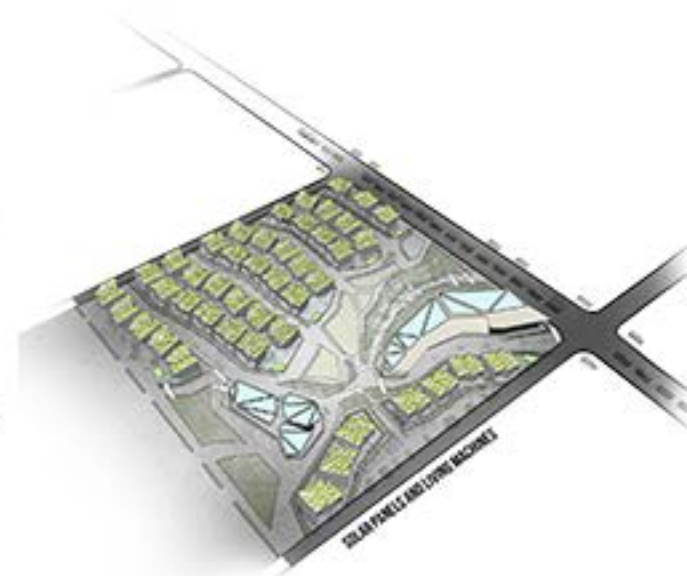

HOUSING COMMUNITY



GREY WATER RECYCLED FOR POTABLE PURPOSES

BLACK WATER RECYCLING FOR IRRIGATION AND BATHROOMS

COMMUNAL GARDEN



DRIP IRRIGATION RECEIVES WATER FROM RECYCLED BLACKWATER



FIRST FLOOR PLAN BLOW-UP



SECOND FLOOR PLAN BLOW-UP

USING THE ARCHITECTURAL STYLE OF
ELEMENTAL CHILEAN DESIGN AS
PRECEDENT FOR THE EXPANDING AND
REGENERATIVE APPROACH TO HOUSING.
THESE STRUCTURES ARE MEANT TO
ACHIEVE MULTI-GENERATIONAL SPACES
PROMOTING VERSATILITY AS WELL AS
ADJUSTABILITY, FOR DIVERSE
FAMILY NEEDS.



HOUSING & PROGRAM



WOONERF PERSPECTIVE



RESIDENCES & STAGE AREA





SHADE STRUCTURES



GATHERING SPACES



ACCESS TO PRODUCE



SHADE STRUCTURES



ZOCALO PLAN BLOW-UP



COMMERCIAL ELEMENTS & ZOCALO



