

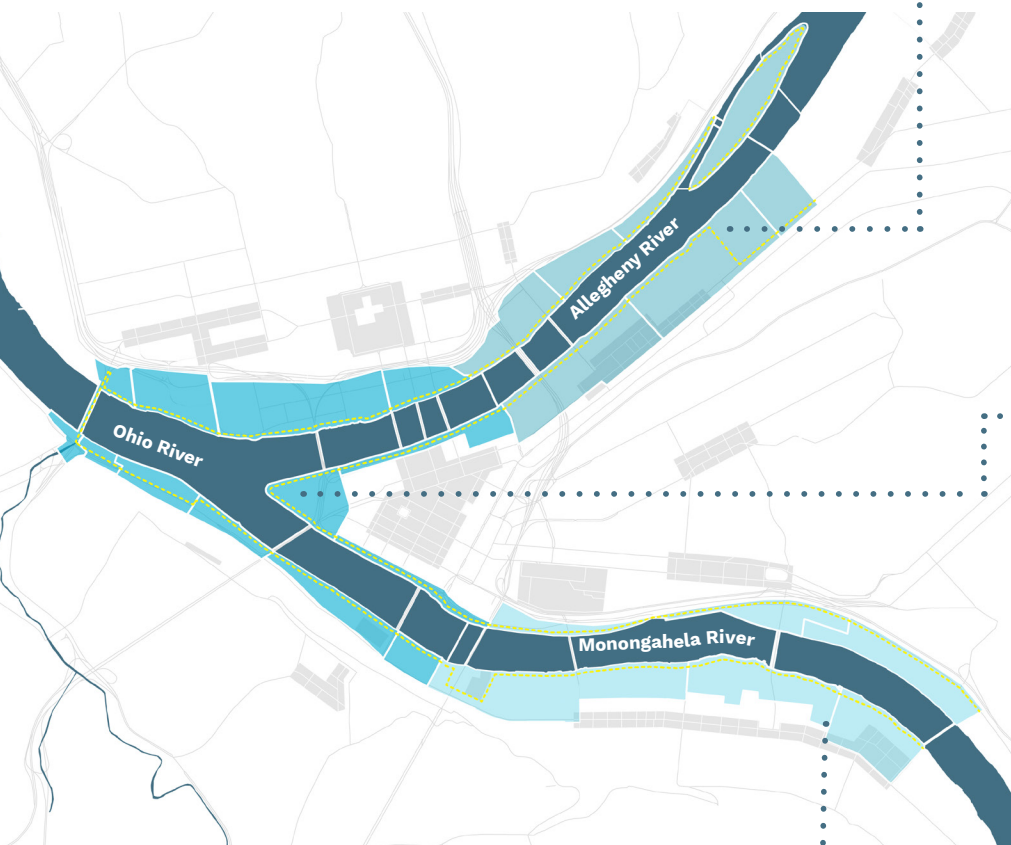

Riverlife is dedicated to reimagining Pittsburgh's riverfronts as a continuous system of parks and open space referred to as "the Loop". The Completing the Loop report articulates Riverlife's vision, imagines projects for a world-class riverfront, and aligns the efforts of many stakeholders to create vibrant, equitable places.

River Rooms



SD RA WL

ALLEGHENY River Room

5 miles of riverfront
1 public river landing

Strip District
River Avenue
Washington's Landing

WE NS GT SQ

CONFLUENCE River Room

6 miles of riverfront
Point State Park
Allegheny Landing Park
North Shore Riverfront Park
4 public river landings

West End
North Shore
Golden Triangle
Station Square

SS SA

MONONGAHELA River Room

4 miles of riverfront
South Shore Riverfront Park
South Side Riverfront Park
3 public river landings

South Side
Second Avenue Corridor

At 1055 acres, Pittsburgh's three River Rooms are equivalent to Frick Park and Schenley Park combined.

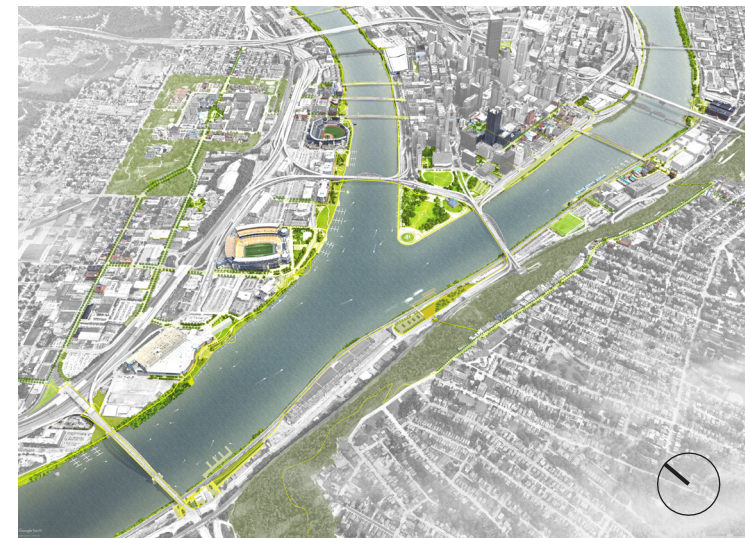

Confluence

River Room

Allegheny Landing & Allegheny Riverfront Park

Renovate parks on both sides of the river

Manchester Gateway

New under bridge gateway park at north edge of West End Bridge

Mon Wharf Activation

Kayak launch, lighting, seasonal activities, and **partial highway cap**

Station Square Landing

Expand and improve docks

Neighborhood Loop: Mt. Washington

Trail and incline station improvements

Saw Mill Run Gateway

Riverfront park and landing with **accessible connection** to the river and bridge

Allegheny River

Monongahela River

Ohio River



Manchester Gateway Park River Level

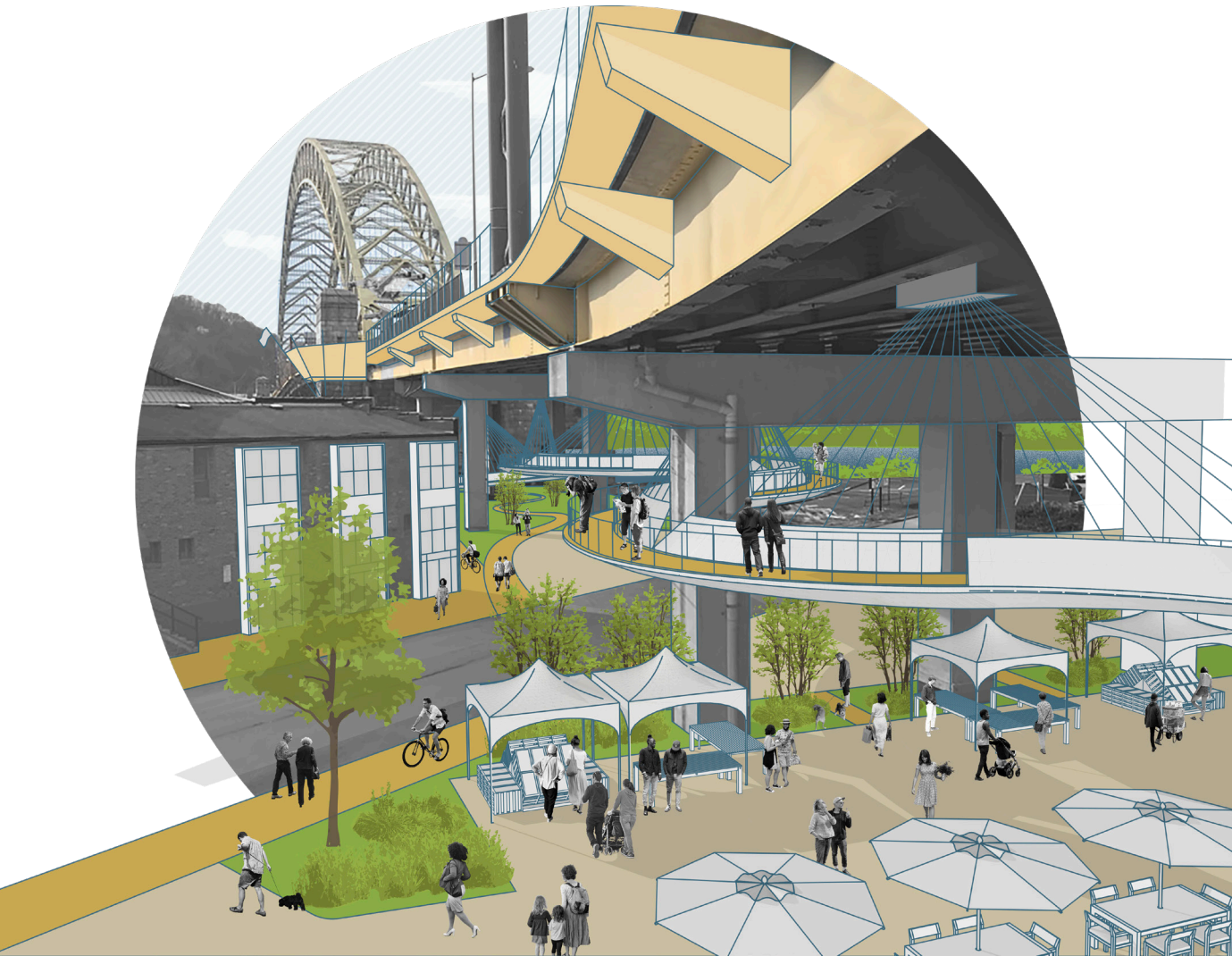

Manchester was separated from the river by a midcentury highway. This project provides a critical riverfront link to the reconnect to the neighborhood. An underbridge park transforms a parking lot into a signature destination.



- 1 serpentine path connecting Manchester to the river
- 2 new accessible ramp to the river
- 3 expand existing ramp
- 4 seasonal event space and park
- 5 trailhead parking for the Loop
- 6 underbridge plaza

Saw Mill Run Gateway Park

River Level

At the peak of Pittsburgh's industrial prowess, people avoided the rivers, and the mills' demise left degraded landscapes and large-scale contamination. Today Riverlife is cultivating restorative riverscapes for all species.

- 1 art installation to celebrate Saw Mill Run and outflow
- 2 Saw Mill Run Gateway landing
- 3 ecopark and seasonal event space
- 4 riverfront path connecting to Station Square
- 5 incubator office space for artists / nonprofits coop
- 6 trailhead and location of future westward trails
- 7 rejuvenate existing structures

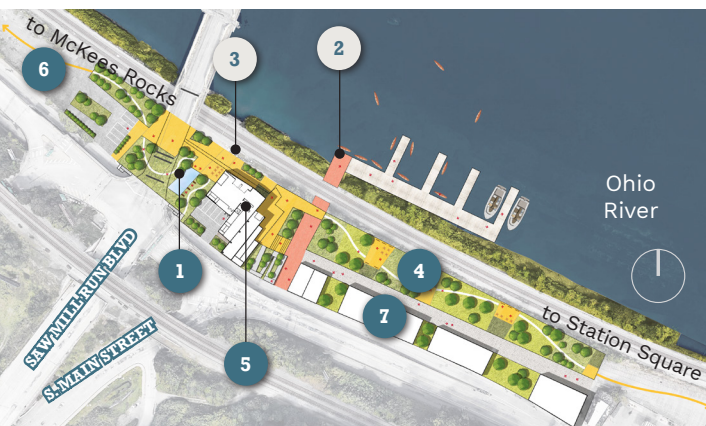
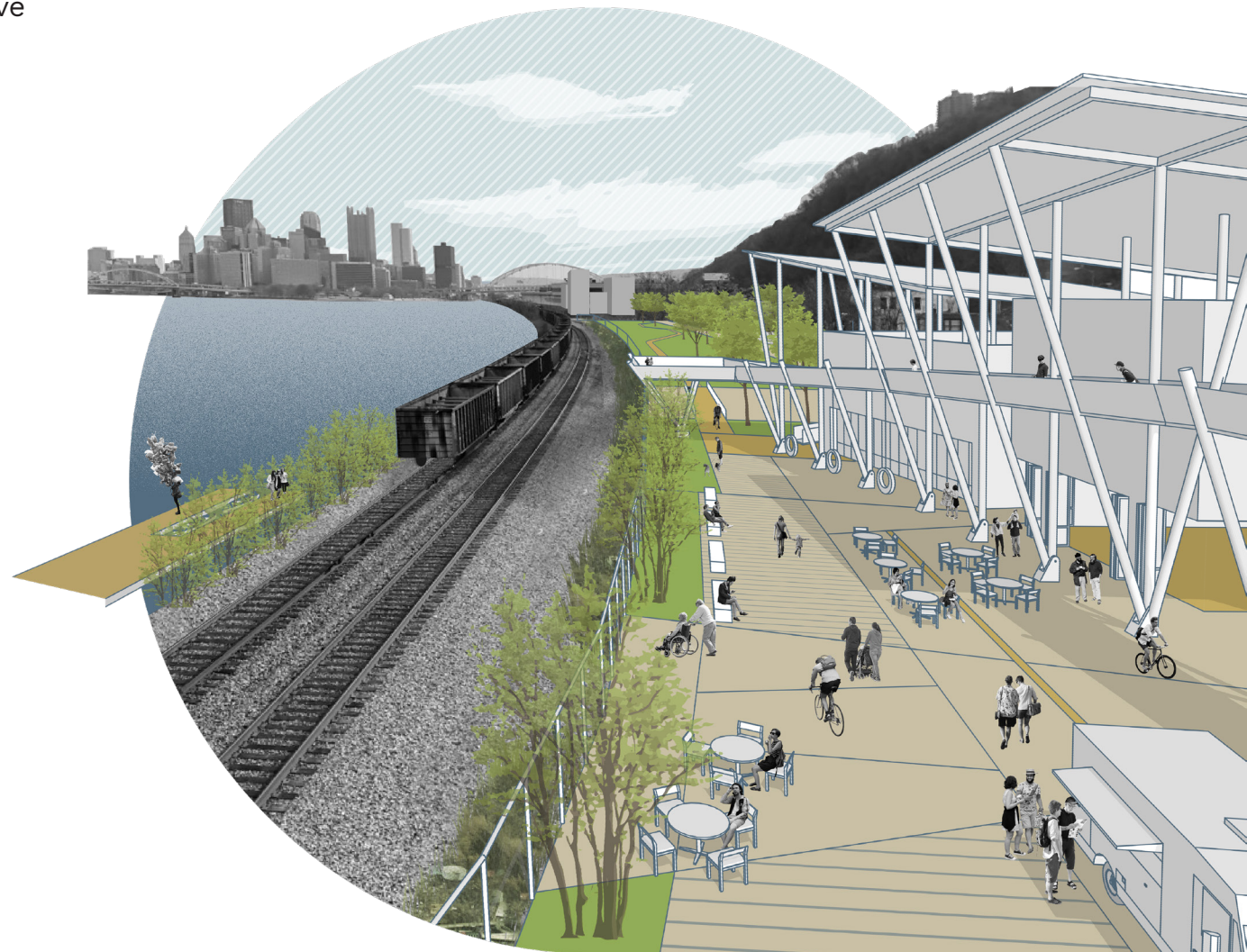

Manchester Gateway Park
Neighborhood Connection



West End Bridge Improvements
Multimodal Connections

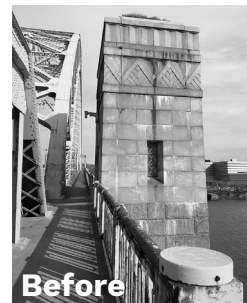

By connecting neighborhoods to major destinations, the Loop becomes a safe and inviting alternative to driving so more people can walk, bike, paddle, or use other carbon-free or low-impact modes of travel.

By connecting Pittsburgh's two inclines into a "neighborhood loop," Mt. Washington residents can access regional trails and waterfront amenities and businesses can better accommodate visitors.



0.8 mile between upper incline stations

- 1 new landing for small craft and kayak rental
- 2 lower plaza for incline, including accessible route to river and decked parking
- 3 expanded Station Square Landing and improved public areas
- 4 future development site

Allegheny River Room

Neighborhood Loop:
Strip District
**Connect Penn Avenue
business district to the river**

Strip Landings and
Riverbank Restoration
**Activate the shoreline
and restore ecology**

City Landing Park
**New public park with
river access**

River Avenue District
**Link River Avenue and
waterfront development**

Allegheny
River

Neighborhood Loop:
Troy Hill
**Green streets, intersection
improvements, and wayfinding**

River Avenue Trailhead
**Connects to 31st Street
Bridge and River Avenue**



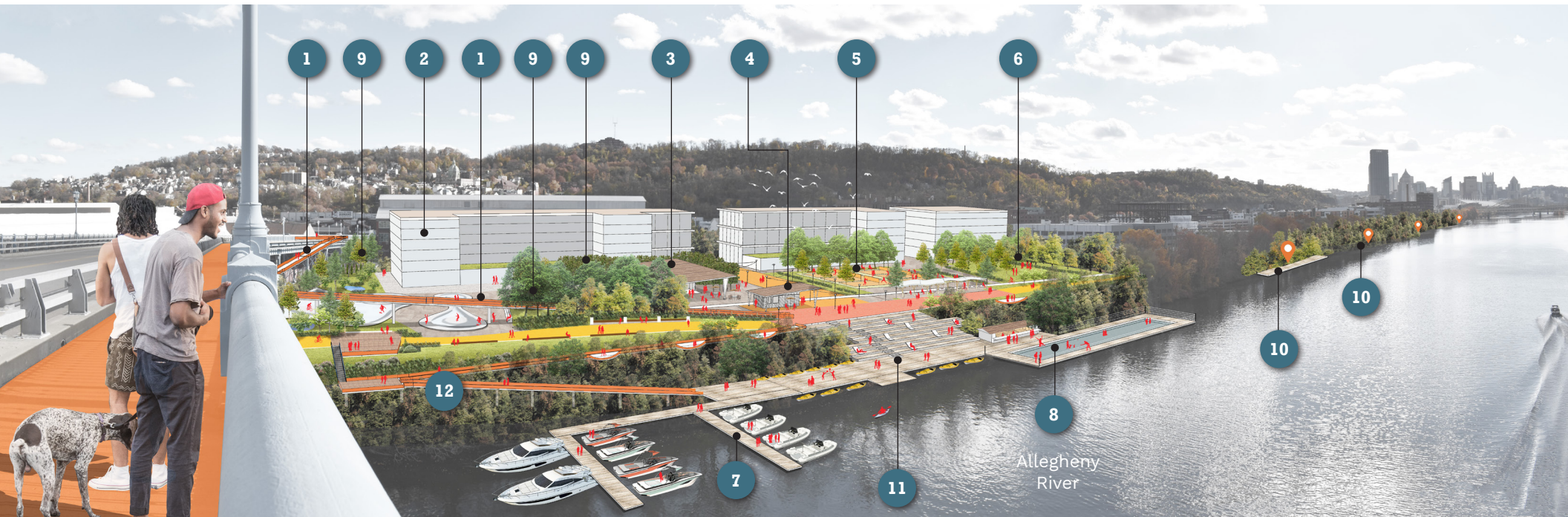

- | | | | | | |
|---|---------------------------|---|---------------------|----|------------------------------|
| 1 | accessible ramp to bridge | 5 | active recreation | 9 | forest rooms |
| 2 | anchor development | 6 | passive recreation | 10 | strip district landings |
| 3 | cafe | 7 | river landing/docks | 11 | riverfront beach steps |
| 4 | kiosk | 8 | swim barge | 12 | accessible path to the river |

The transformation of a city-owned tow pound into public riverfront access and permanently affordable housing will provide much needed green space and ensure diversity of incomes in a rapidly gentrifying warehouse district.

New trailheads raise the visibility of the Loop and enhance it with safe, culturally and ecologically rich entry points for people driving, walking or biking to the rivers.



Space for plants, parking, food trucks and temporary activities

Safer, off-street sidewalk

Destination signage and traffic calming



Monongahela River Room

Nearby Neighborhood Loops:
The Hill, Uptown, Oakland, & Schenley Park

Connect city neighborhoods and parks
to the river and Eliza Furnace Trail

Nearby Neighborhood Loop:
Carson Street

Green streets and wayfinding

Park Extension & Bridge
Connection

Riverfront park expansion and
new bridge ramp

Riverbank Restoration

**Improve structural and
ecological conditions**

Fourth Street Landing

**Trail and landing
improvements**

Monongahela
River



Adding trees and vegetation to restore habitat and increasing air and water quality monitoring will enable trail users, industry, and the railroad to safely coexist. An art installation will protect trail users below existing industrial structures.

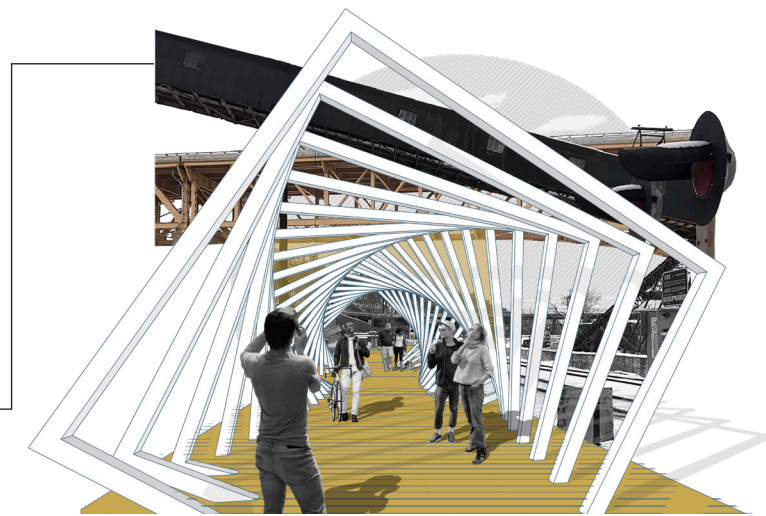

- 1 expanded kayak landing
- 2 Fourt Street trailhead
- 3 highline-station square connector
- 4 future station square east development

The plan coordinates public and private entities that have the responsibility for caring for the trails' hardscape and living materials with guidelines and a funding plan that account for "stewardship" and not just "maintenance."

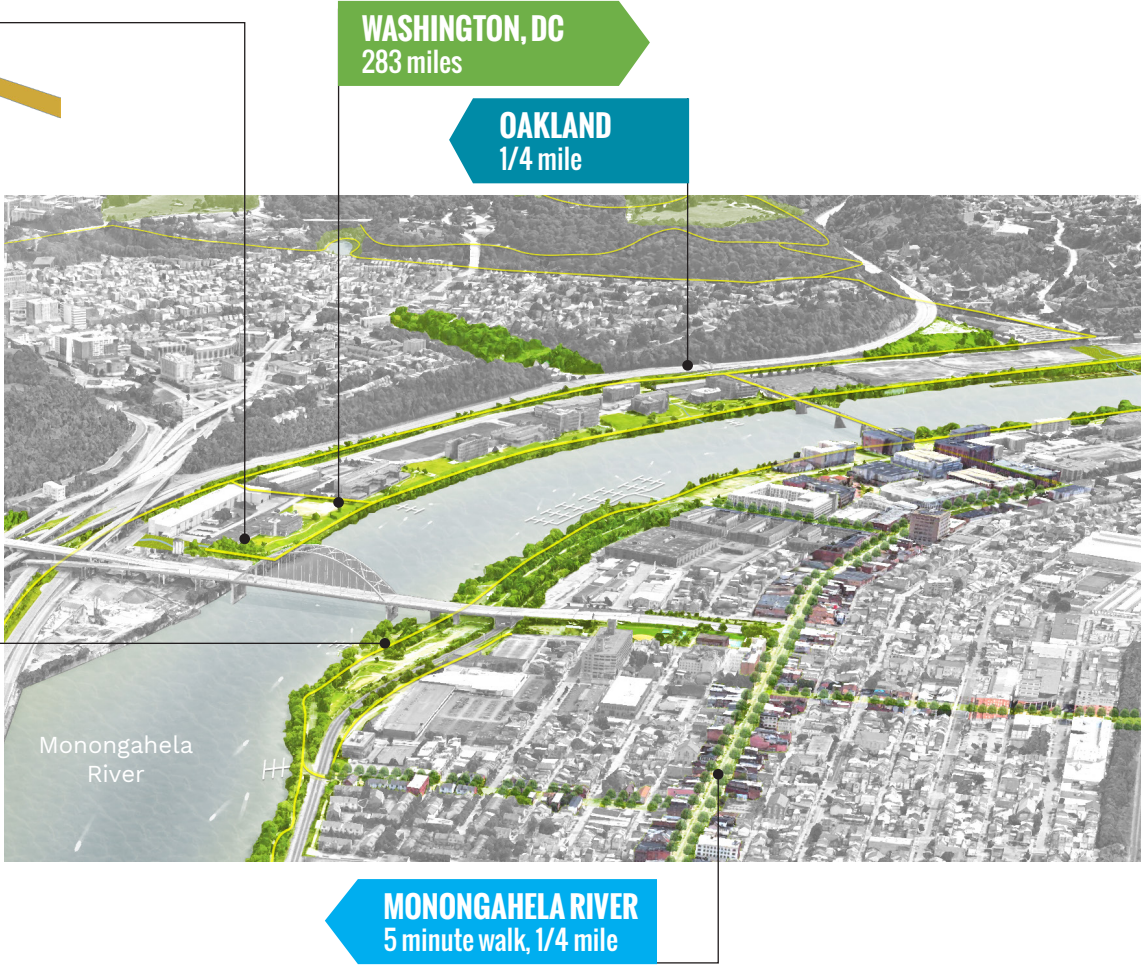



There is much work to be done. 15 neighborhoods with over 41,000 people are within a 15-minute walk of the water. Yet few neighborhoods identify as riverfront communities.

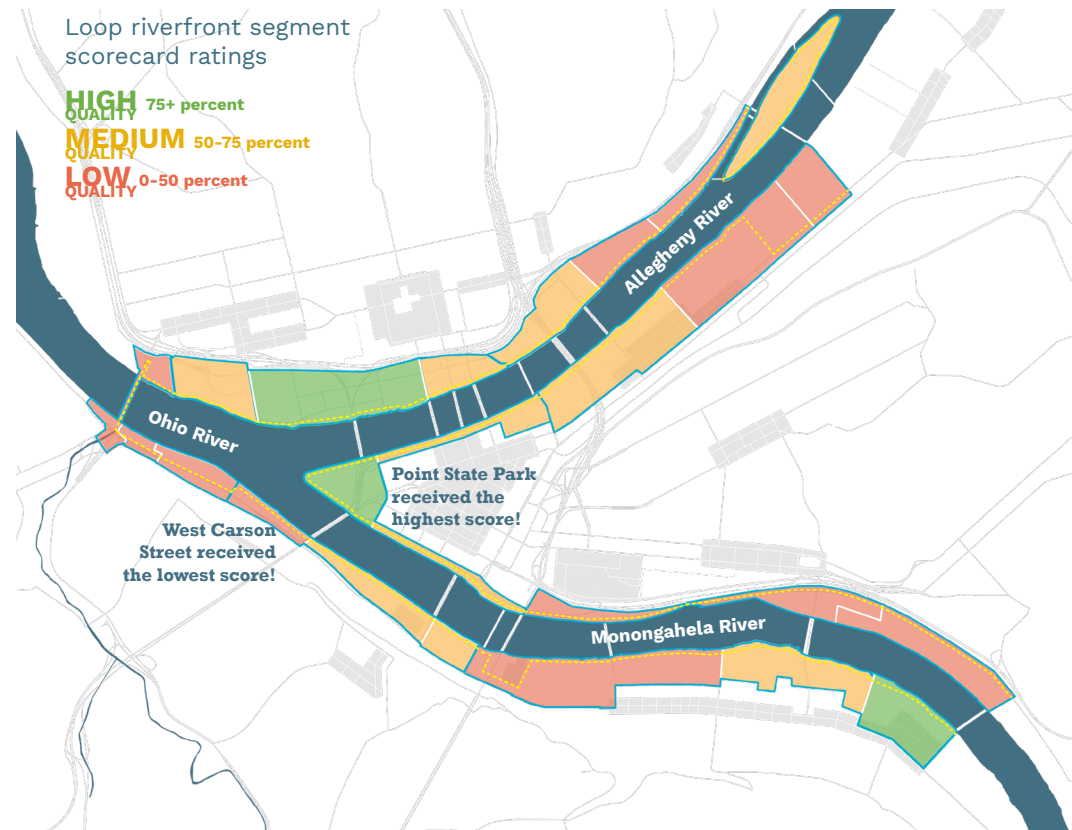

◀ Current conditions along the Loop

Pleasant, well lit, and safe crossings under railroads and over highways will connect nearby neighborhoods and institutions to the river.

