

# Rewilding: Co-create With Birds

Context: Fishtown Neighborhood

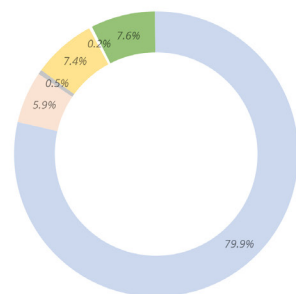

2011 Race and Ethnicity

White  
Black or African American  
American Indian and Alaska Native  
Asian  
Native Hawaiian and Other Pacific Islander  
Some other race

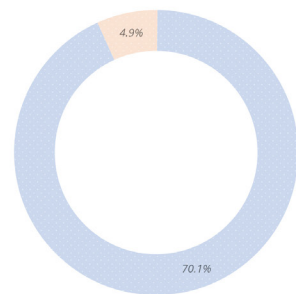

Employment

Employed  
Unemployed

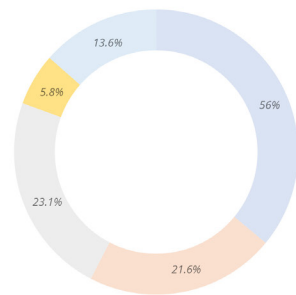

Occupation

Management, business, science, etc.  
Service occupations  
Sales and office occupations  
Natural resources, construction, etc.  
Production, transportation, etc.



The site is located at the riverfront of Fishtown, Philadelphia. It is adjacent to PECO Delaware Generating Station and separated from the rest of neighborhood by I-95. It features typical post-industrial characteristics, such as being desolate, abandoned, and inaccessible.

## Qualitative Sections: Capture Site Condition

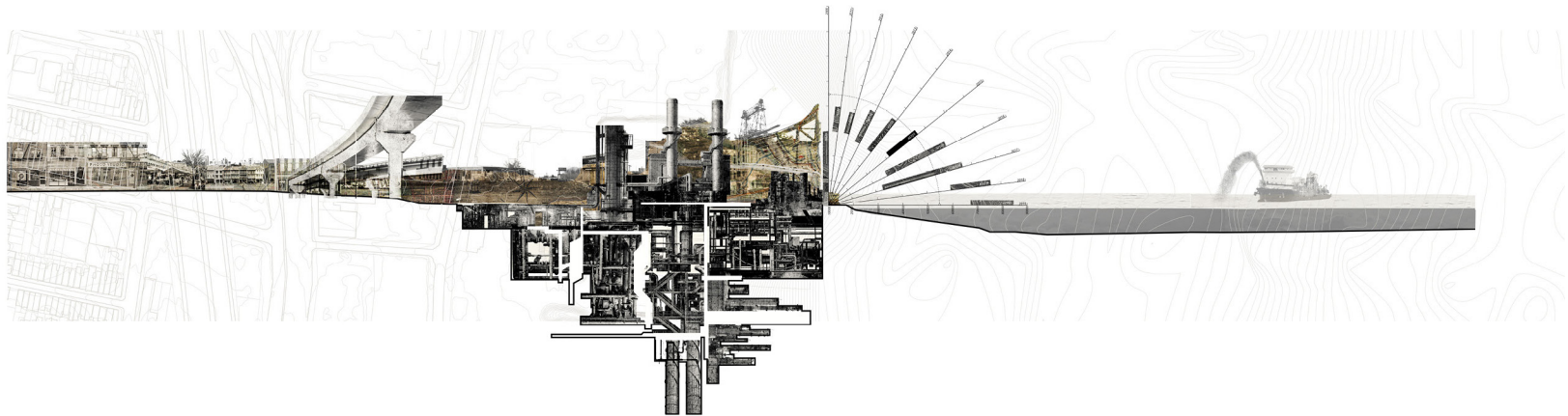

It's interesting to see a variety of species take up their individual niches and thrive without any human intervention and management. Besides, the industrial past is progressively fading away and I-95 separates the riverfront from the rest of the neighborhood.



Wildness Through Different Lenses

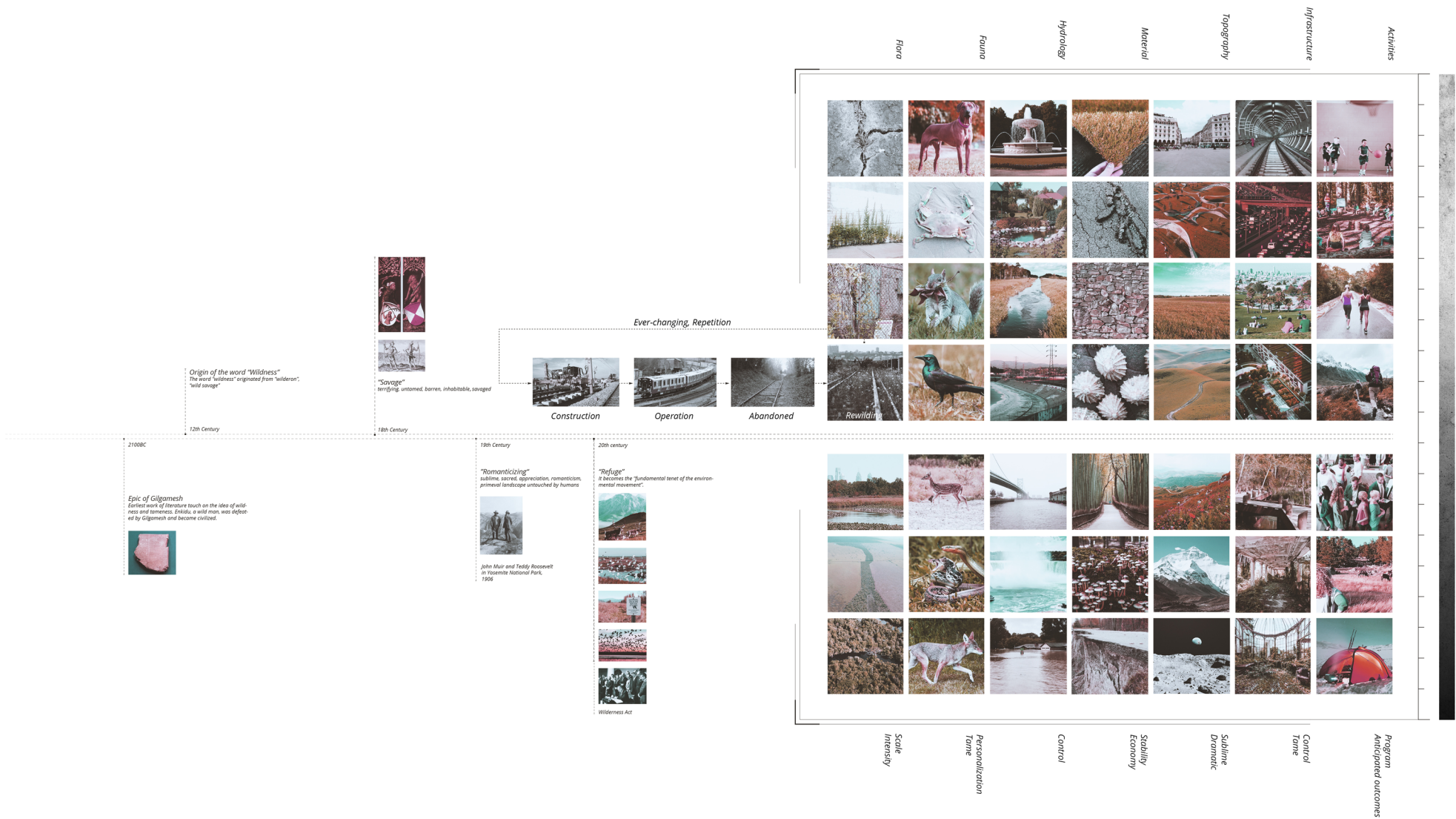

The wild scenery creates contrast with well-manicured landscape and inspired me to explore the idea of wildness. I cataloged and visualized my interpretation of wildness in terms of hydrology, topography, etc., and organized it from the least to most wild.

Birds Behaviour Analysis

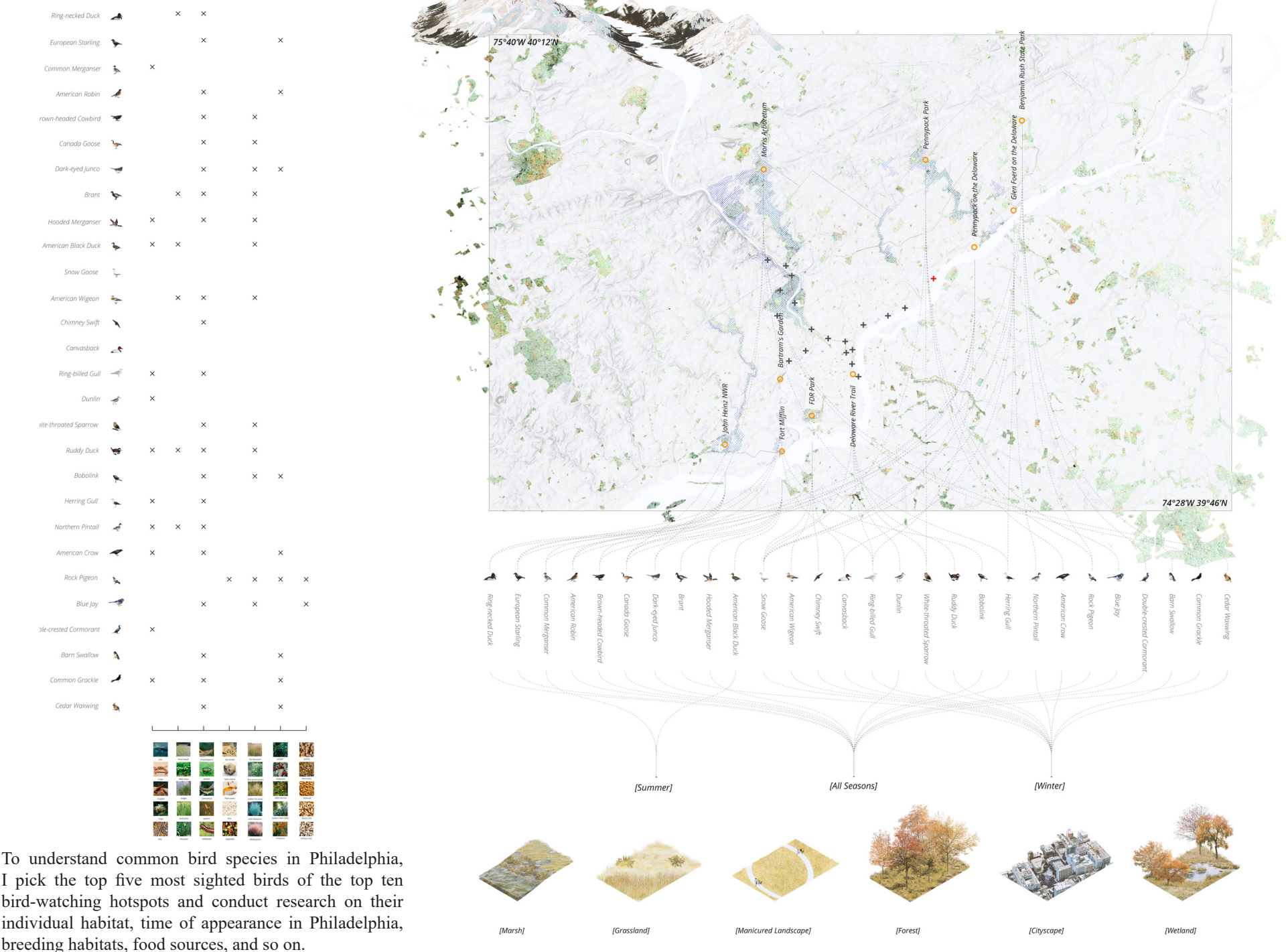

To understand common bird species in Philadelphia, I pick the top five most sighted birds of the top ten bird-watching hotspots and conduct research on their individual habitat, time of appearance in Philadelphia, breeding habitats, food sources, and so on.



## Generative Program

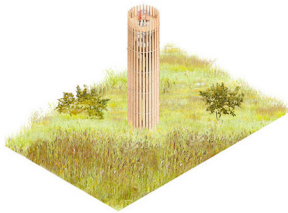

*Lookout Tower*

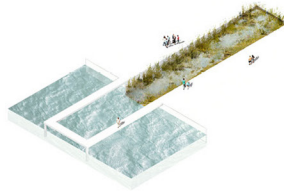

*Extended Boardwalk*



*Wetland Trail*



*Elevated Boardwalk*



*Forest Walk*

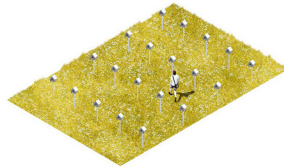

*Birdhouse Showcase*



*Bird Bath*

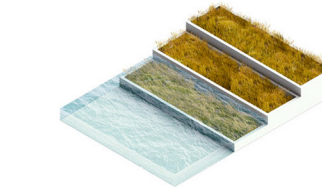

*Terraced Wetland*



*Large Gather Area*

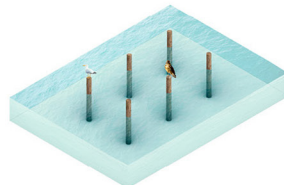

*Bird Posts*

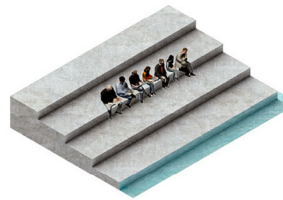

*Gather Space along River*



*Sunflower Framed Trail*

Drawing upon the wildness catalog diagram and information about bird behavior, a series of programs, including but not limited to twelve, are developed and serve as flexible references for future steps.

# Organization Strategies

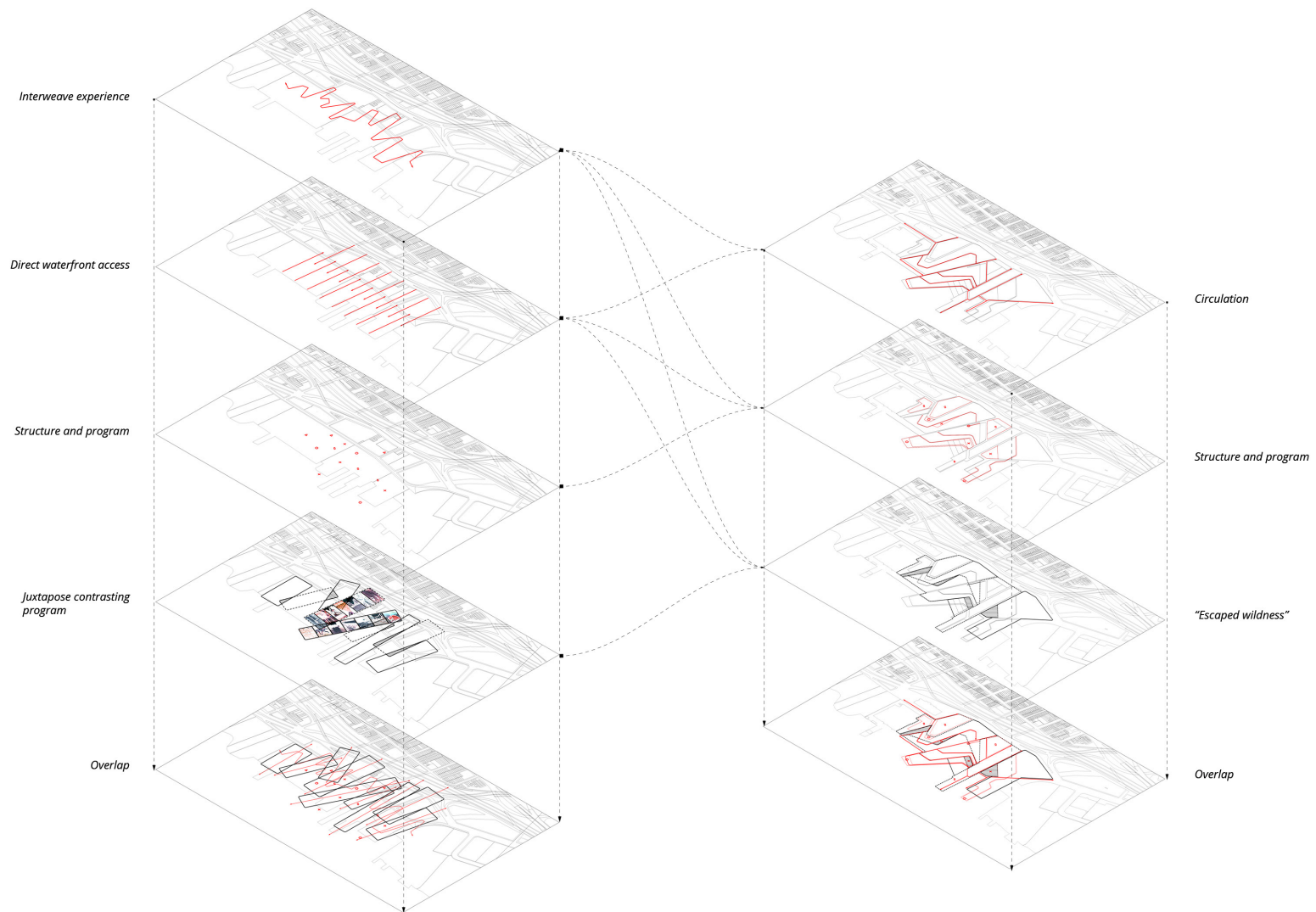

I juxtapose contrasting conditions labeled as domesticated, artificial, and order with abandoned, spontaneous, and messy. Programs are interweaved by the circulation. Visitors are slowed as they go horizontally across the site, yet they also have direct access to the waterfront.



# Plan

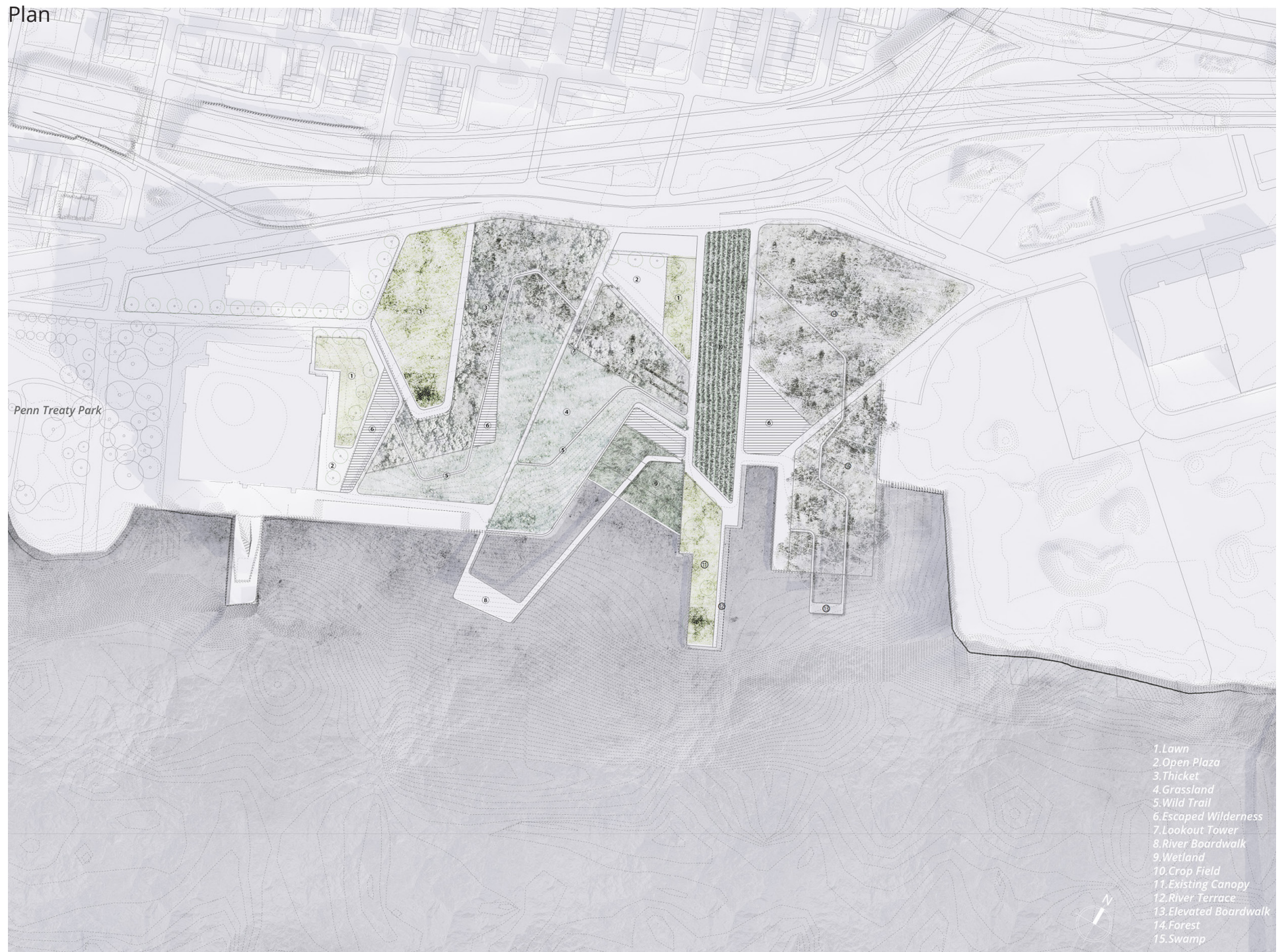



# Plant Selection and Maintenance

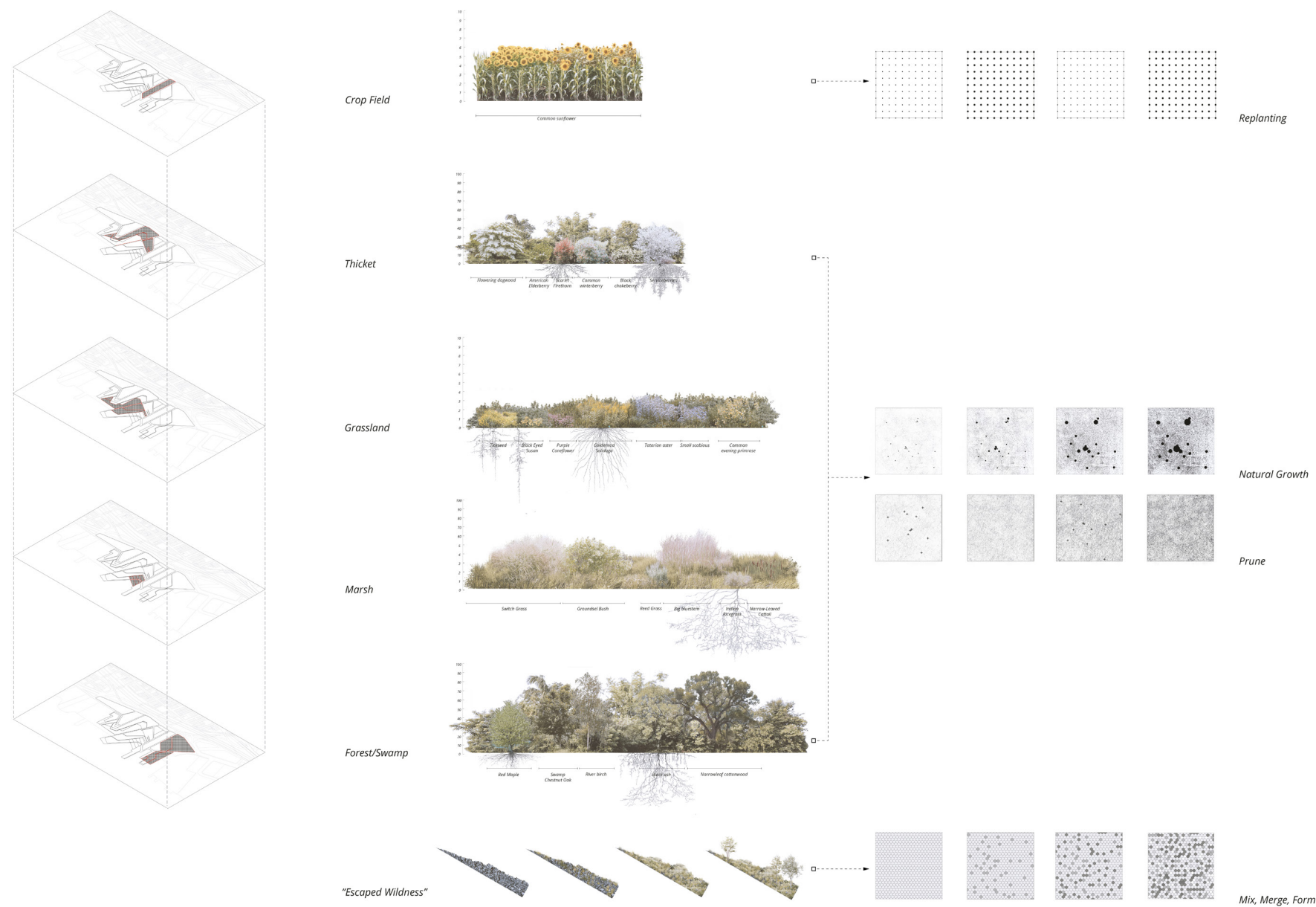

To attract a large number of birds, it is necessary to provide a variety of food sources, appropriate living conditions, and nesting habitats. They're organized into various frames, and various maintenance techniques are applied to maintain the desired condition.



Adaption: Tidal Fluctuation and Extreme Flooding Event

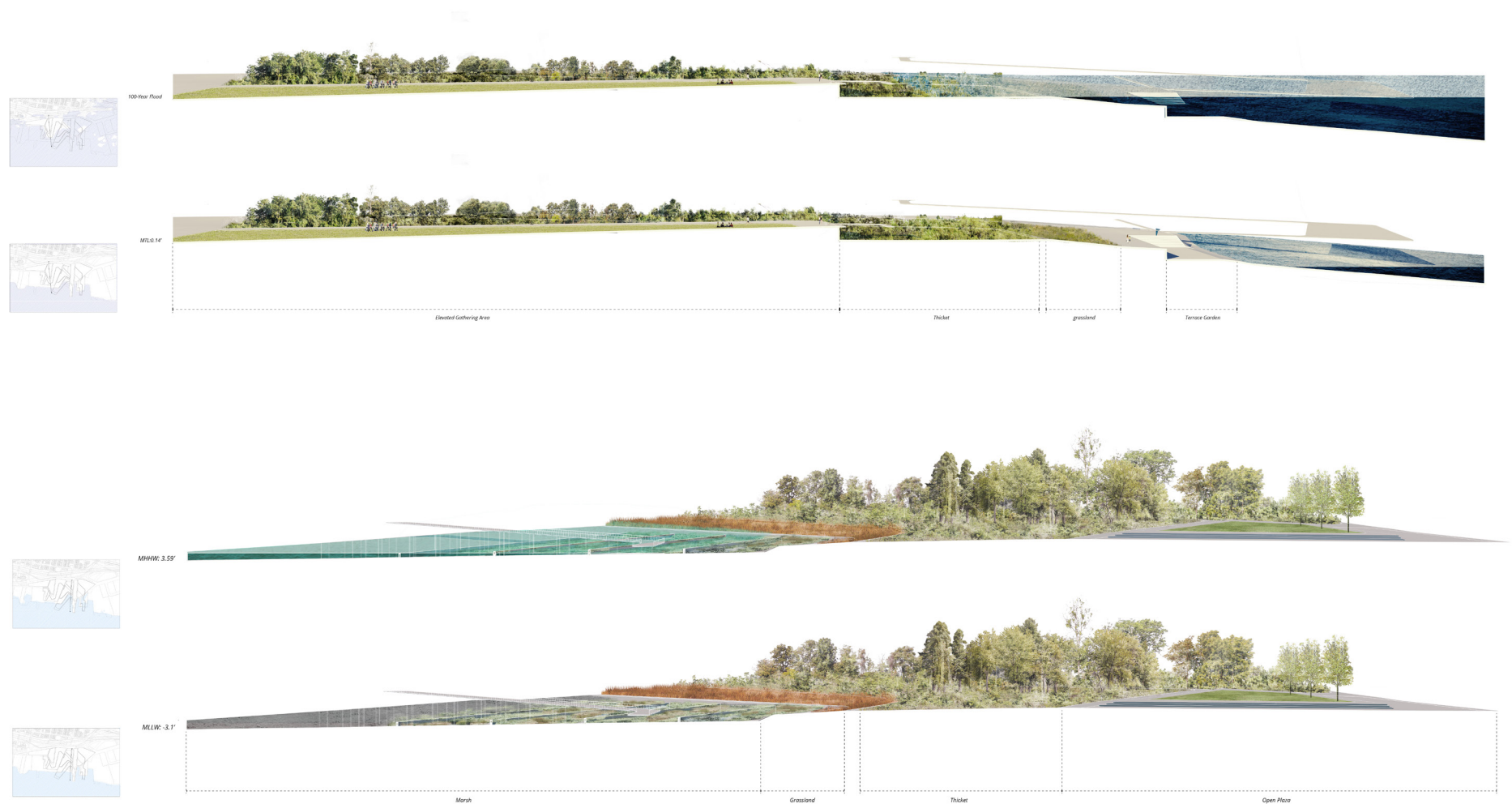

Marsh and partial grassland area experience daily tidal fluctuation, which create a dynamic experience for visitors. During the 100-year flooding event, the elevated platform is still accessible by visitors.



Axonometric Render

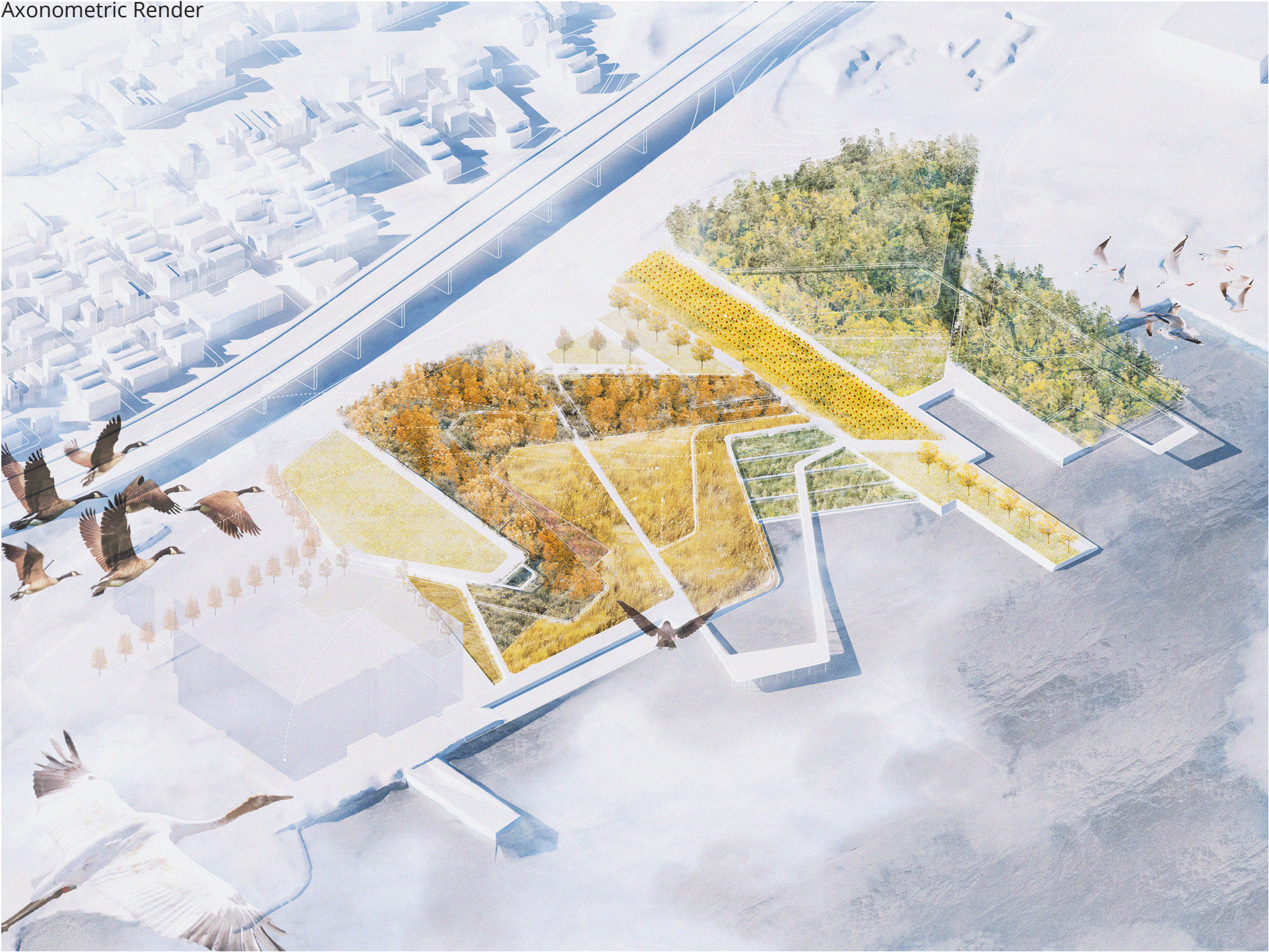



Swamp and Bird Blind

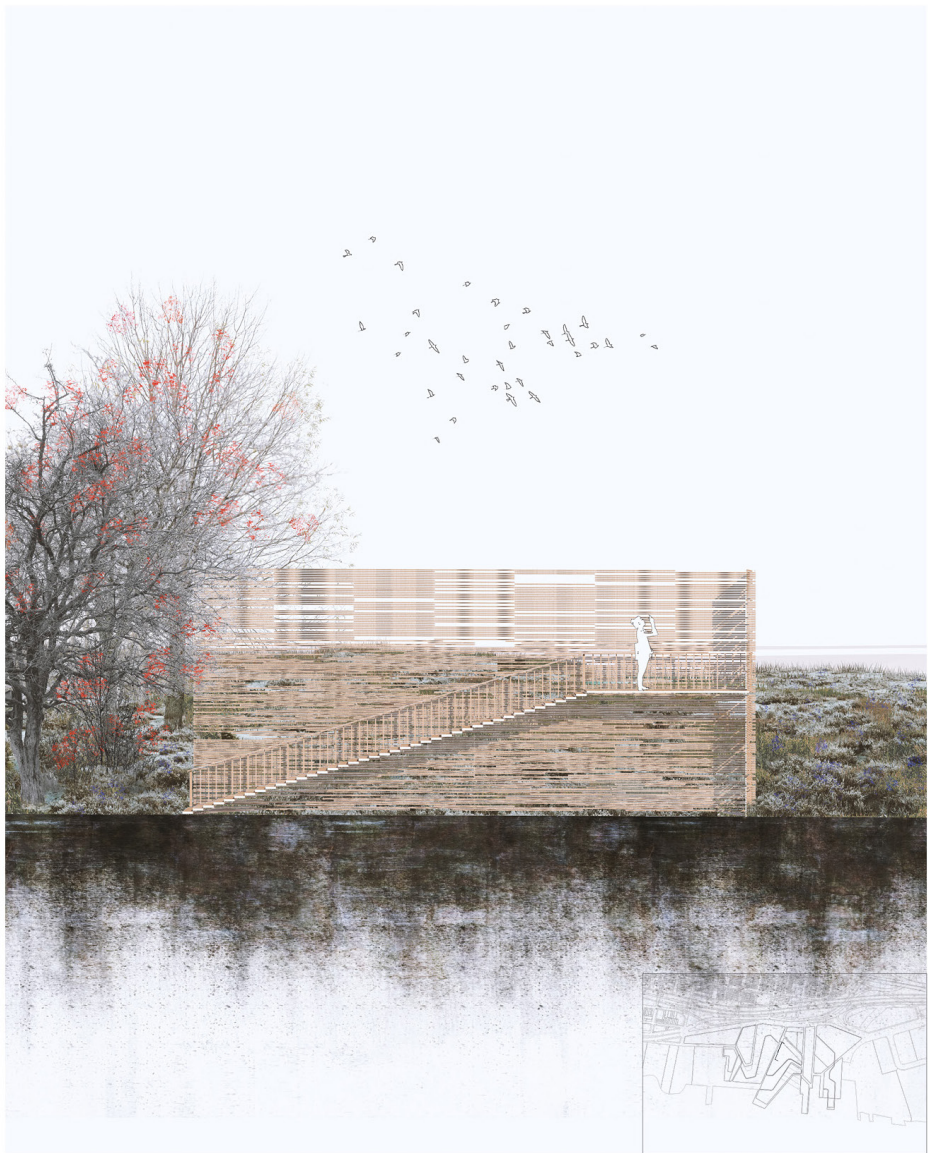

During the winter, berries are available and provide food for migratory birds.



Upland Forest and Swamp

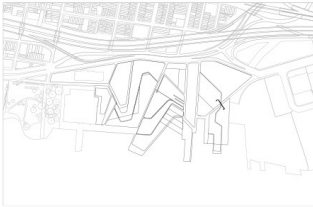
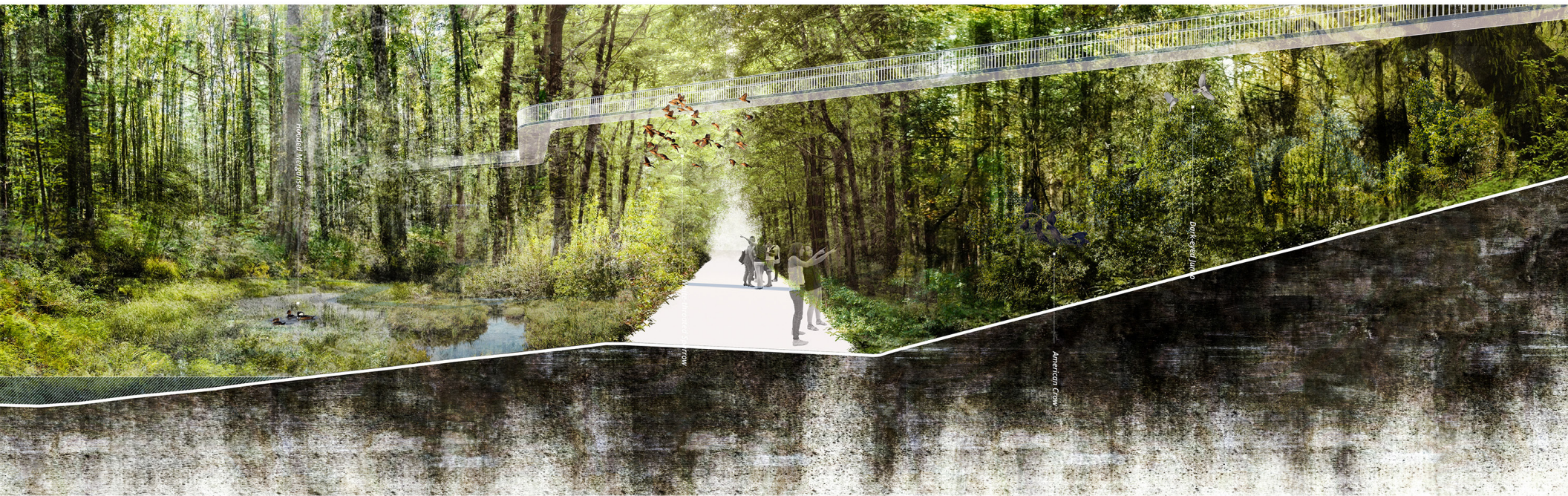

The dense canopy creates an enclosed environment that allows visitors to fully immerse themselves in the forest.



## Messiness: View From Skywalk

Bird house forest serve as visual anchor point to locate a variety of bird species.



## Order: River View From Plaza

The overlapping area between the plaza and grassland area provides wilderness platforms to escape the frame and generate unintended habitat. The edge effect and implementation of bird baths will facilitate the new growth.





## Domestication: View From the Sunflower Field

Sunflower seeds attract a large number of birds, creating a sensory experience when traveling across a field in the early fall. Some of the seeds will be collected for next year's planting.



## Uncertainty: View From Grassland

The thicket and grassland area form a distinct contrast with the well-organized plaza area. Bird houses or perches could be made by the community members and installed their design at the beginning of the construction.

